



Replaceable core filter drier shells (liquid line)

→ BDCY / BCY / BCY-HP (46 bar)

■ Applications

- Refrigerant filtering and drying and acid neutralization for refrigerating and air conditioning installation liquid lines.
- Replaceable core filter drier shells allow the replacement of the filter drier's active parts only.

NEW
BCY-HP : G1 & G2

Shell reference	Core reference (size)
BDCY	CCY 42
BCY / BCY-HP	CCY 48 / PLATINIUM 48
BCY-P6 / BCY-P14	PLATINIUM 48 / CCY 48
BBCY	CCY 100 / PLATINIUM 100



Customized product in stainless steel

Standard product

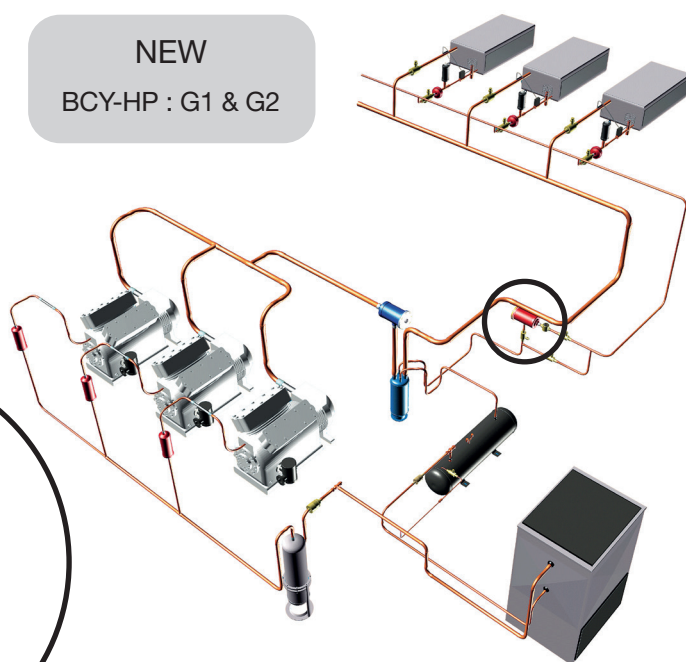

■ Functional features

- Products are compatible with HCFCs, HFCs, HFO, HC, CO₂, as well as with their associated oils and additives. Products are designed for use of refrigerants from group 2 of PED 2014/68/EU. To use CARLY components with group 1 fluids, contact CARLY technical department.
- Product classification in CE categories is performed using the PED 2014/68/EU table, corresponding to a volume-based selection.
- Filtering at outlet preventing the propagation within the circuit of particles bigger than 150 microns, with a very low pressure drop.
- 1/4" NPT taper tapping and its plug on end plate, allowing the installation of a pressure tap or a feeding valve.
- End plate perfectly tight thanks to its circular rim and its gasket compatible with all HCFCs, HFCs, HFOs, HCs and CO₂s.



Possible customization on demand:

- Stainless steel casings and connections (corrosion resistance and for use at very low temperature).
- PS 46 bar for BCY-HP 3 and 4 cores.

■ CARLY advantages

- Maximum working pressure : up to 46 bars for the BCY-HP 1 and 2 cartridges.
- Individual core holders treated against corrosion by zincoating, with a reduced course for easy core replacement; therefore, replacement time is extremely reduced, limiting the time the drying cores and the inner part of the circuit are exposed to the atmosphere.
- Hermetically sealed external body made of steel to which an impregnation varnish and paint are applied to ensure a high resistance to corrosion ; this varnish ensures the internal anti-corrosion protection of the shell when it is opened for the initial set-up or during the replacement of the drying cores.
- Core holder design ensures automatic and immediate centring in the filter drier shells.
- No flow area restriction outside the filter drier shells thanks to an appropriate filtering system.



Replaceable core filter drier shells (liquid line)

→ BDCY / BCY / BCY-HP (46 bar)

■ Warning

Before selecting or installing any component, please refer to the chapter 0 - **WARNING**.

■ General assembly precautions

The installation of a component in a refrigeration system by a skilled professional, requires some precautions:

- Some are specific to each component, and in this case, they are specified in the

RECOMMENDATIONS SPECIFIC part defined hereafter ;

- Other are general to all CARLY components, they are presented in the chapter 115 – **GENERAL ASSEMBLY PRECAUTIONS**.

- The recommendations relating to the CARLY components for the subcritical CO₂ applications are also developed in chapter 115 – **GENERAL ASSEMBLY PRECAUTIONS**.

■ Specific recommendations to replaceable core filter drier shells BDCY / BCY / BCY-HP

- Filter drier shells are to be mounted on the liquid line between the receiver and the expansion element.
- The refrigerant flow direction, indicated by an arrow on the filter drier shells' tags, should be complied with.
- Assembly can be performed in any position, but not vertically with the outlet connection oriented downwards.
- During filter drier shells assembly, provide for sufficient course to allow core replacement (refer to sizes L2 in the technical features table).
- The connection to the installation, by soldering or welding, of the filter shell, must be done only after removing the closing flange, its gasket and the internal core holders.
- We recommend to clean and to protect the connections of the filter drier shell with appropriate products in order to ensure a good resistance to corrosion of the affected areas.
- Be careful to properly select the solenoid valves located downstream of the filter drier shells; their oversizing could cause liquid hammer phenomena hindering the filter drier shells' proper mechanical behaviour; protection of the regulation elements upstream of the evaporator should be performed with FILTRY dirt filters (refer to chapter 11); these liquid hammer phenomena can originate from other sources, in long-piping installations.
- Never install filter drier shells in an area of the circuit that can be isolated.
- Never trap refrigerant in its liquid state (between a check valve and a solenoid valve, for instance).
- The filter drier shells' efficiency and the refrigerant's moisture content should be checked using VCYL or VCYLS liquid sight glasses (refer to chapter 9 or 10).
- Make sure that the piping can support without deformation the weight of the filter drier shell ; otherwise, provide for a clamp of the filter drier shell with a clamp on a stable part of the installation.
- In order to avoid risk of frost and condensation on the suction filter shells mounted on a cold pipe, it is recommended to insulate them thermally.

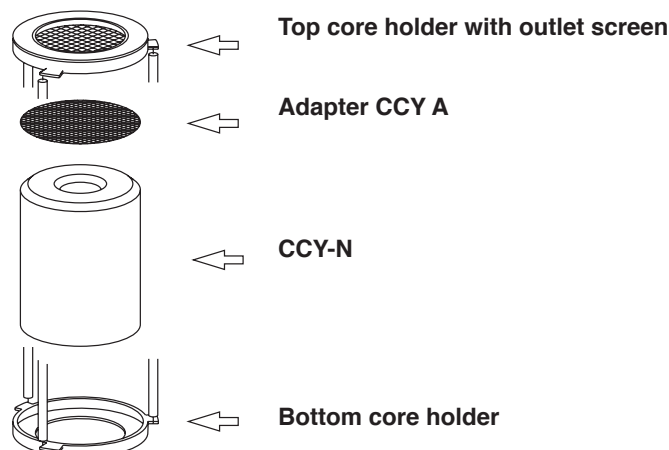



Replaceable core filter drier shells (liquid line)

→ **BDCY** (corresponding cores: CCY 42)

■ Core replacement procedure

- 1 • Isolate the **BDCY** filter drier shell.
- 2 • Purge the installation up to atmospheric pressure (shell should be empty of refrigerants)
- 3 • Remove the end plate.
- 4 • Remove the bottom core holder.
- 5 • Remove the used core.
- 6 • Clean and replace if necessary, the **CCY A 42** adapter.
- 7 • Check and replace if necessary, the outlet gasket of top core holder.
- 8 • Replace systematically the end plate gasket.
- 9 • Remove the **CCY 42** core from its sealed can.
- 10 • Reassemble in order: the **CCY A 42** adapter (1), the outlet gasket (2), the top core holder (3), the **CCY 42** core, the bottom core holder and its compression spring (4) (sketch below)
- 11 • Reinstall the closing flange making sure that the compression spring is correctly positioned and gradually and uniformly tighten the closing screws (refer to chapter 115 – **GENERAL MOUNTING PRECAUTIONS** – Criss-cross tightening). Maximum bolt tightening torque: 30 N.m.
- 12 • Make sure that the end plate's 1/4" NPT taper tapping has been properly plugged in and sealed.
- 13 • Make vacuum in the installation and check air-tightness of the whole set before putting back under pressure.

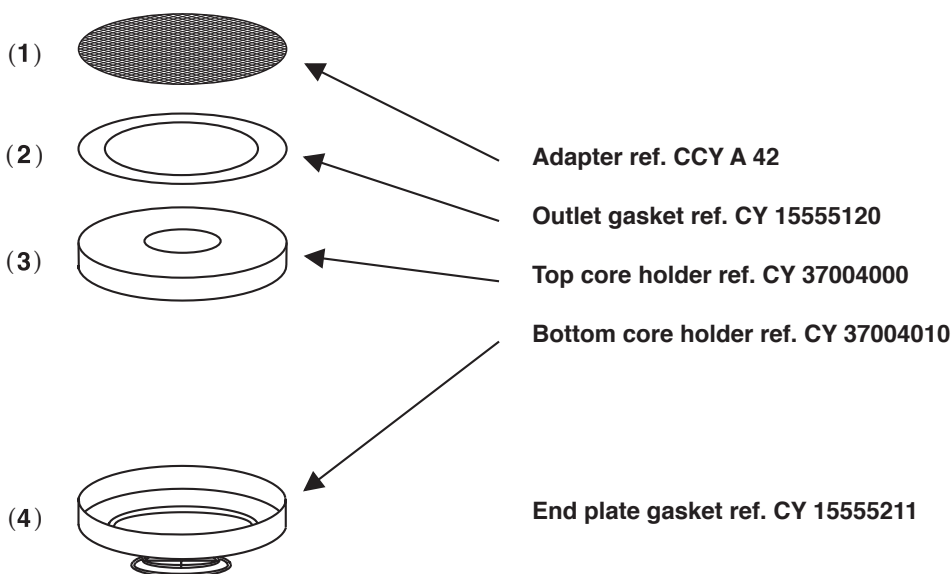



CTCY-EN - 5.1-9 / 03-2025

Replaceable core filter drier shells (liquid line)

→ BDCY (corresponding cores: CCY 42)

■ Selection table

CARLY references	Connections To solder ODF inch	CARLY references	Connections To solder ODF mm	Refrigerating capacity kW ⁽¹⁾					Number of cores
				R22 R1233zd	R134a R407C R410A R407F	R404A R507A R452A	R1234ze R513A R448A R449A R450A	R744 ⁽²⁾	
BDCY 424 S	1/2	BDCY 424 MMS	12	19,0	17,0	12,0	15,0	22,0	1
BDCY 425 S/MMS	5/8	BDCY 425 S/MMS	16	27,0	25,0	18,0	22,0	31,0	1
BDCY 427 S/MMS	7/8	BDCY 427 S/MMS	22	45,0	41,0	29,0	36,0	51,0	1

⁽¹⁾ Refrigerating capacities according to Standard ARI 710-86 for $T_o = -15\text{ °C}$, $T_k = 30\text{ °C}$ and $\Delta p = 0.07\text{ bar}$.
If different conditions, refer to correction factors in chapter 112.

⁽²⁾ Refrigerating capacities Q_n for $T_k = -10\text{ °C}$ and $T_o = -40\text{ °C}$
If different conditions, refer to correction factors in chapter 112.

Nota: the diameter of connections must not be inferior to the diameter of the main pipe.

■ Technical features

CARLY references	Connection types ⁽¹⁾	Filtering surface cm ²				Dimensions mm						
		CCY 42 HP CCY 42 N	CCY 42 F	CCY 42 I	Ø1	Ø2	Ø3	L1	L2	E1	E2	
BDCY 424 S	BDCY 424 MMS	2	374	329	348	89	96	124	218	210	152	65
BDCY 425 S/MMS		2	374	329	348	89	96	124	220	210	155	67
BDCY 427 S/MMS		2	374	329	348	89	96	124	230	210	163	76

⁽¹⁾ Chapter «Connection features and drawings» (refer to chapter 114).

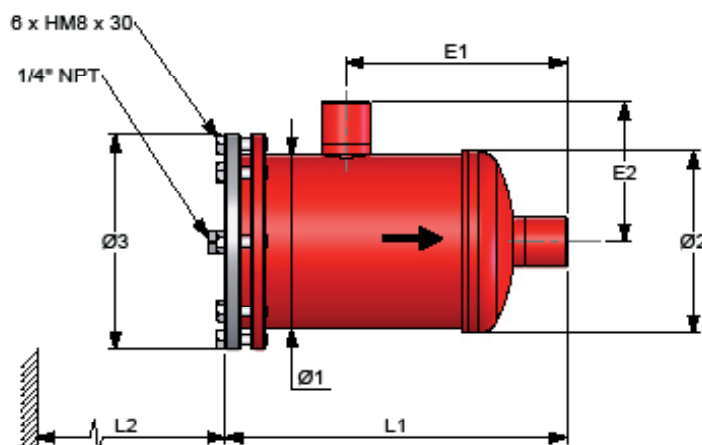

CARLY references	Volume V L	Maximal working pressure PS bar	Working pressure ⁽¹⁾ PS BT bar	Maximal working temperature TS maxi °C	Minimal working temperature TS mini °C	Working temperature ⁽¹⁾ TS BT °C	CE Category ⁽²⁾	
								BDCY 424 S
BDCY 425 S/MMS		1,00	42	15	100	-40	-30	Art4§3
BDCY 427 S/MMS		1,10	42	15	100	-40	-30	Art4§3

⁽¹⁾ The working pressure is limited to the PS BT value when working temperature is lower than or equal to TS BT value.

⁽²⁾ Classification by volume, according to PED 2014/68/EU (refer to chapter 0).



Replaceable core filter drier shells (liquid line)

→ **BDCY** (corresponding cores: CCY 42)

■ Spare parts

CARLY references	Part N°	Description	Quantity
CY 19900410	1	Set of 6 fastening screws for end plate	1
CY 10810010	2	1/4" NPT phosphate plug for end plate	1
CY 33301000	2 + 3 + 5	1/4" NPT plug + end plate + gasket	1
CY 37004010	4	Bottom core holder	1
CY 15555211	5	End plate gasket (red)	1
CY 37004000	6	Top core holder	1
CCY A 42	7	Adapter for end core holders	1

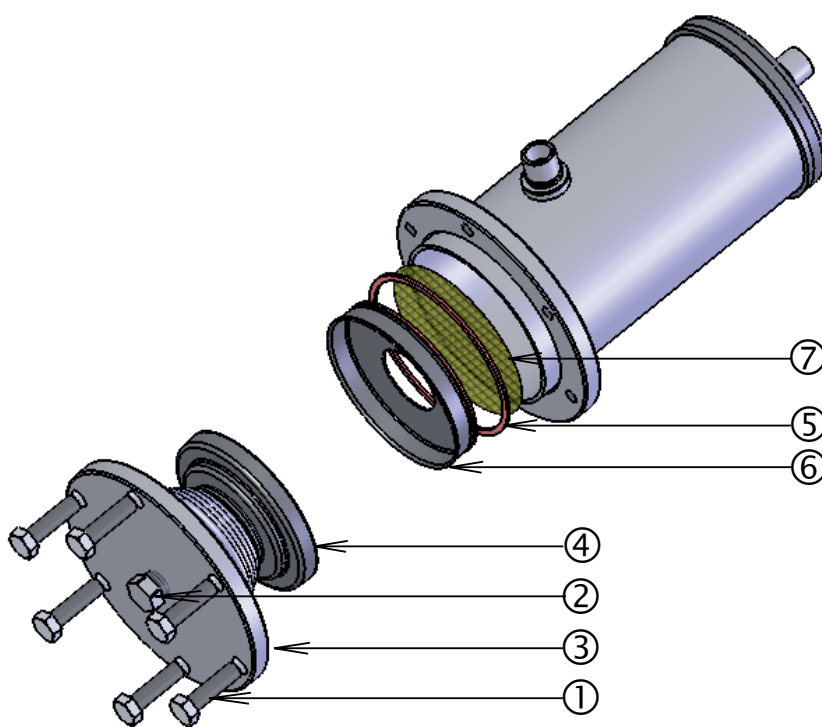

■ Weights and packaging

CARLY references	Unit weight kg		Packaging number of pieces
	With packaging	Without packaging	
BDCY 424 S & MMS	2,85	2,60	1
BDCY 425 S/MMS	2,90	2,65	1
BDCY 427 S/MMS	2,95	2,70	1



Replaceable core filter drier shells (liquid line)

→ **BCY / BCY-HP** (corresponding cores: CCY 48 and PLATINIUM 48)

■ Core replacement procedure

- 1 • Isolate the **BCY / BCY-HP** filter drier shell.
- 2 • Purge the installation up to atmospheric pressure (shell should be empty of refrigerants)
- 3 • Remove the end plate.
- 4 • Remove the core holders one after the other.
- 5 • Remove the used cores.
- 6 • Clean very carefully the core holders, the adapter (**CCY A 48**) and the inner part of the shell case.
- 7 • Replace systematically the gasket on the end plate and check the core holder and core end gaskets.
- 8 • Remove the core from its can and put it on the core holder, separating by traction the two flanges that hold the core holder (sketch 1)
- 9 • Repeat the operation for each core holder.
- 10 • Quickly install the core holders with their core in the shell, complying with their mounting order: the first one holds the filter elements and the last one is the one equipped with the compression spring (sketch 2)
- 11 • Reinstall the closing flange making sure that the compression spring is correctly positioned and gradually and uniformly tighten the closing screws (refer to chapter 115 – **GENERAL MOUNTING PRECAUTIONS** – Criss-cross tightening). Maximum bolt tightening torque: 30 N.m.
- 12 • Make sure that the end plate's 1/4" NPT taper tapping has been properly plugged in and sealed.
- 13 • Make vacuum in the installation and check air-tightness of the whole set before putting back under pressure.

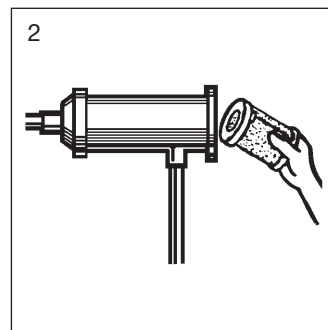
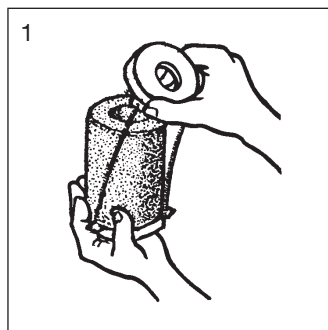

⚠ The standard gasket of the CCY (neoprene) is not compatible with CO₂. Use the reference CY 15555200.



Replaceable core filter drier shells (liquid line)

CTCY-EN - 5.1-9 / 03-2025

➔ **BCY** (corresponding cores: CCY 48 and PLATINIUM 48)

■ Selection table

CARLY references	Connections To solder ODF inch	CARLY references	Connections To solder ODF mm	Refrigerating capacity kW ⁽¹⁾					Number of cores
				R22 R1233zd	R134a R407C R410A R407F	R404A R507A R452A	R1234ze R513A R448A R449A R450A	R744 ⁽²⁾ CO ₂	
BCY 485 S/MMS	5/8	BCY 485 S/MMS	16	93,5	86,0	61,0	75,0	106,0	1
BCY 487 S/MMS	7/8	BCY 487 S/MMS	22	152,0	139,0	100,0	121,0	171,0	1
BCY 489 S	1 1/8	BCY 489 MMS	28	206,0	188,0	135,0	163,5	232,0	1
BCY 4811 S/MMS	1 3/8	BCY 4811 S/MMS	35	246,0	225,0	161,0	196,0	277,0	1
BCY 4813 S	1 5/8	BCY 4813 MMS	42	298,5	273,0	195,0	237,5	336,0	1
BCY 4817 S/MMS	2 1/8	BCY 4817 S/MMS	54	348,5	319,0	228,0	277,5	392,0	1
BCY 967 S/MMS	7/8	BCY 967 S/MMS	22	156,0	143,0	102,0	124,5	176,0	2
BCY 969 S	1 1/8	BCY 969 MMS	28	234,0	214,0	153,0	186,0	264,0	2
BCY 9611 S/MMS	1 3/8	BCY 9611 S/MMS	35	332,5	304,0	217,0	264,5	375,0	2
BCY 9613 S	1 5/8	BCY 9613 MMS	42	408,0	373,0	267,0	324,5	460,0	2
BCY 9617 S/MMS	2 1/8	BCY 9617 S/MMS	54	412,0	377,0	269,0	327,0	464,0	2
BCY 1449 S	1 1/8	BCY 1449 MMS	28	373,0	341,0	244,0	296,5	420,0	3
BCY 14411 S/MMS	1 3/8	BCY 14411 S/MMS	35	398,0	364,0	260,0	316,5	448,0	3
BCY 14413 S	1 5/8	BCY 14413 MMS	42	413,0	378,0	270,0	329,0	465,0	3
BCY 14417 S/MMS	2 1/8	BCY 14417 S/MMS	54	443,0	405,0	290,0	352,0	499,0	3
BCY 19213 S	1 5/8	BCY 19213 MMS	42	522,5	478,0	342,0	416,0	588,0	4
BCY 19217 S/MMS	2 1/8	BCY 19217 S/MMS	54	557,0	510,0	364,0	443,5	628,0	4

⁽¹⁾ Refrigerating capacities according to Standard ARI 710-86 for $T_o = -15\text{ °C}$, $T_k = 30\text{ °C}$ and $\Delta p = 0.07\text{ bar}$.
If different conditions, refer to correction factors in chapter 112.

⁽²⁾ Refrigerating capacities Q_n for $T_k = -10\text{ °C}$ and $T_o = -40\text{ °C}$
If different conditions, refer to correction factors in chapter 112.

Nota: the diameter of connections must not be inferior to the diameter of the main pipe.



CTCY-EN - 5.1-9 / 03-2025

Replaceable core filter drier shells (liquid line)

➔ **BCY** (corresponding cores: CCY 48 and PLATINIUM 48)

■ Technical features

CARLY references	Connection types ⁽¹⁾	Filtering surface cm ²	Dimensions mm							
			Ø1	Ø2 ⁽²⁾	Ø3	L1	L2	E1	E2	
BCY 485 S/MMS	2	420	121	128	150	223	210	139	83	
BCY 487 S/MMS	2	420	121	128	150	233	210	149	93	
BCY 489 S	BCY 489 MMS	3	420	121	128	150	238	210	154	98
BCY 4811 S/MMS		3	420	121	128	150	247	210	163	108
BCY 4813 S	BCY 4813 MMS	3	420	121	128	150	247	210	163	108
BCY 4817 S/MMS		3	420	121	128	150	260	210	176	124
BCY 967 S/MMS		2	840	121	128	150	373	210	289	93
BCY 969 S	BCY 969 MMS	3	840	121	128	150	378	210	294	98
BCY 9611 S/MMS		3	840	121	128	150	387	210	303	108
BCY 9613 S	BCY 9613 MMS	3	840	121	128	150	387	210	303	108
BCY 9617 S/MMS		3	840	121	128	150	400	210	316	124
BCY 1449 S	BCY 1449 MMS	3	1260	121	128	150	518	210	434	98
BCY 14411 S/MMS		3	1260	121	128	150	527	210	443	108
BCY 14413 S	BCY 14413 MMS	3	1260	121	128	150	527	210	443	108
BCY 14417 S/MMS		3	1260	121	128	150	540	210	456	124
BCY 19213 S	BCY 19213 MMS	3	1680	121	128	150	672	210	588	108
BCY 19217 S/MMS		3	1680	121	128	150	685	210	601	124

⁽¹⁾ Chapter «Connection features and drawings» (refer to chapter 114).

⁽²⁾ Including weld.

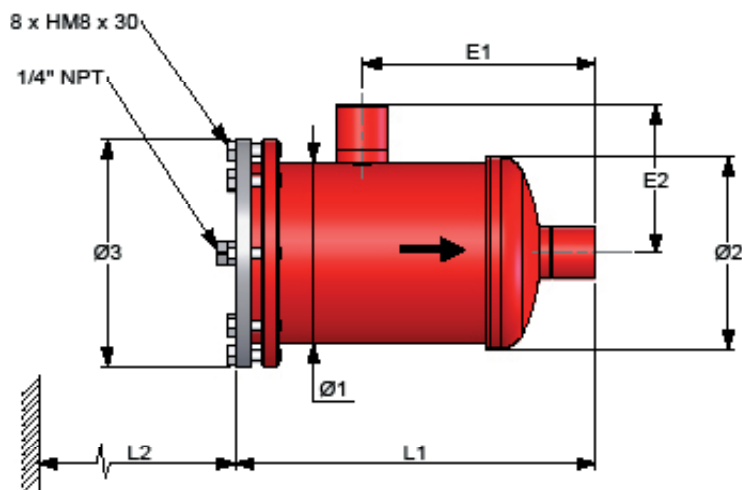



Replaceable core filter drier shells (liquid line)

➔ **BCY** (corresponding cores: CCY 48 and PLATINIUM 48)

■ Technical features

CARLY references	Volume	Maximal working pressure	Working pressure ⁽¹⁾	Maximal working temperature	Minimal working temperature	Working temperature ⁽¹⁾	CE Category ⁽²⁾	
	V L	PS bar	PS BT bar	TS maxi °C	TS mini °C	TS BT °C		
BCY 485 S/MMS	1,90	35	15	100	-40	-30	I	
BCY 487 S/MMS	1,90	35	15	100	-40	-30	I	
BCY 489 S	BCY 489 MMS	1,90	35	15	100	-40	-30	I
BCY 4811 S/MMS		1,90	35	15	100	-40	-30	I
BCY 4813 S	BCY 4813 MMS	1,90	35	15	100	-40	-30	I
BCY 4817 S/MMS		2,00	35	15	100	-40	-30	I
BCY 967 S/MMS		3,30	35	15	100	-40	-30	I
BCY 969 S	BCY 969 MMS	3,30	35	15	100	-40	-30	I
BCY 9611 S/MMS		3,30	35	15	100	-40	-30	I
BCY 9613 S	BCY 9613 MMS	3,30	35	15	100	-40	-30	I
BCY 9617 S/MMS		3,40	35	15	100	-40	-30	I
BCY 1449 S	BCY 1449 MMS	4,90	35	15	100	-40	-30	I
BCY 14411 S/MMS		5,00	35	15	100	-40	-30	I
BCY 14413 S	BCY 14413 MMS	5,00	35	15	100	-40	-30	I
BCY 14417 S/MMS		5,10	35	15	100	-40	-30	I
BCY 19213 S	BCY 19213 MMS	6,40	31*	15	100	-40	-30	I
BCY 19217 S/MMS		6,40	31*	15	100	-40	-30	I

⁽¹⁾ The working pressure is limited to the PS BT value when working temperature is lower than or equal to TS BT value.

⁽²⁾ Classification by volume, according to PED 2014/68/EU (refer to chapter 0).

* 35 bar working pressure possible on demand



Replaceable core filter drier shells (liquid line)

➔ **BCY** (corresponding cores: CCY 48 and PLATINIUM 48)

■ Spare parts

Shells	CARLY References for core holders	Quantity and type of gaskets for use	
		Core holders gasket ⁽¹⁾	End plate gasket ⁽²⁾
BCY 1 core	CY 37001070	1 gasket CY 1555200	
BCY 2 cores	CY 37001030 + CY 37001090	2 gaskets CY 1555200	1 gasket CY 1555601
BCY 3 cores	CY 37001030 + CY 37001090 + CY 37001090	3 gaskets CY 1555200	1 gasket CY 1555601
BCY 4 cores	CY 37001030 + CY 37001090 + CY 37001040 + CY 37001090	4 gaskets CY 1555200	

⁽¹⁾ Gasket delivered with core holders

⁽²⁾ Gasket delivered with cores CCY 48 N, CCY 48 HP and PLATINIUM 48

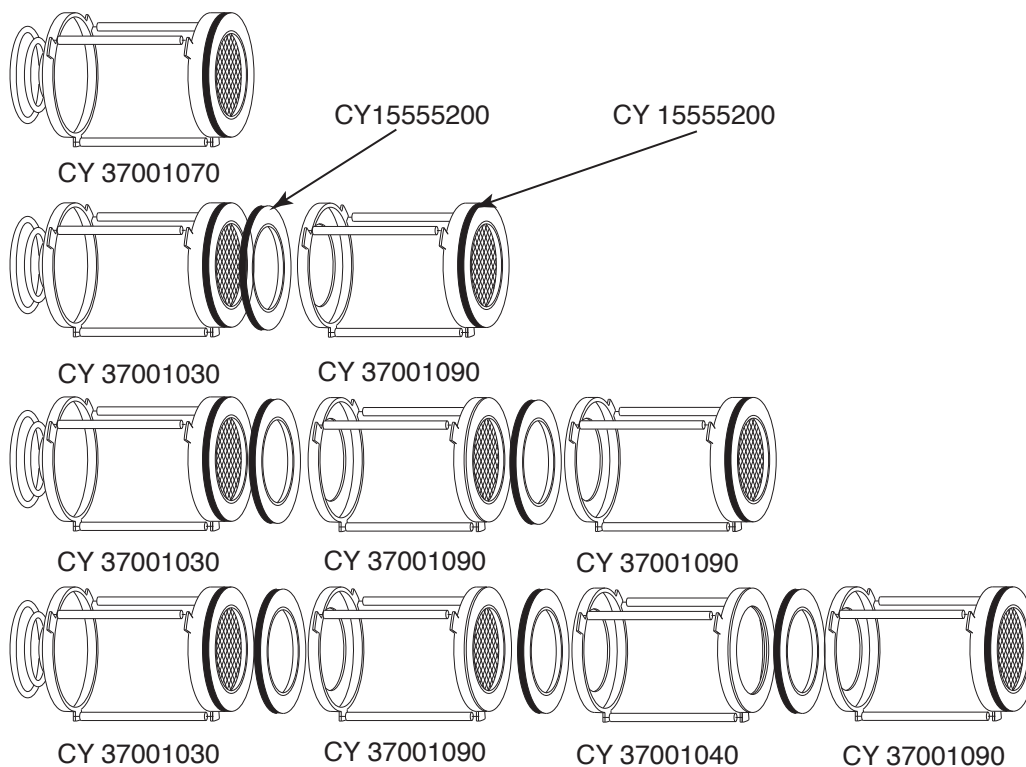



Replaceable core filter drier shells (liquid line)

→ **BCY** (corresponding cores: CCY 48 and PLATINIUM 48)

■ Spare parts

CARLY references	Part N°	Désignation	Quantity
CY 19900411	1	Set of 8 fastening screws for end plate	1
CY 10810010	2	1/4" NPT phosphate plug for end plate	1
CY 33301200	2 + 3 + 5	1/4" NPT plug + end plate + gasket	1
CY 37001030	4	Core holder (2, 3 and 4 cores)	1
CY 37001040	4	Core holder (4 cores)	1
CY 37001070	4	Core holder (1 core)	1
CY 37001090	4	Core holder (2, 3 and 4 cores)	1
CY 15555601	5	End plate gasket (red)	1
CY 15555303	5	End plate gasket (blue)	1
CY 15555200	6	Adhesive gasket for core holders: CY 37001030, CY 37001040, CY37001070, CY37001090	1
CCY A 48	7	Adapter for end core holder	1
CY 15555000		Bag of gaskets for shell end plates : CARLY and for most manufacturers (gaskets: 122 x 114 x 1.6 and 114 x 103 x 1.6)	1

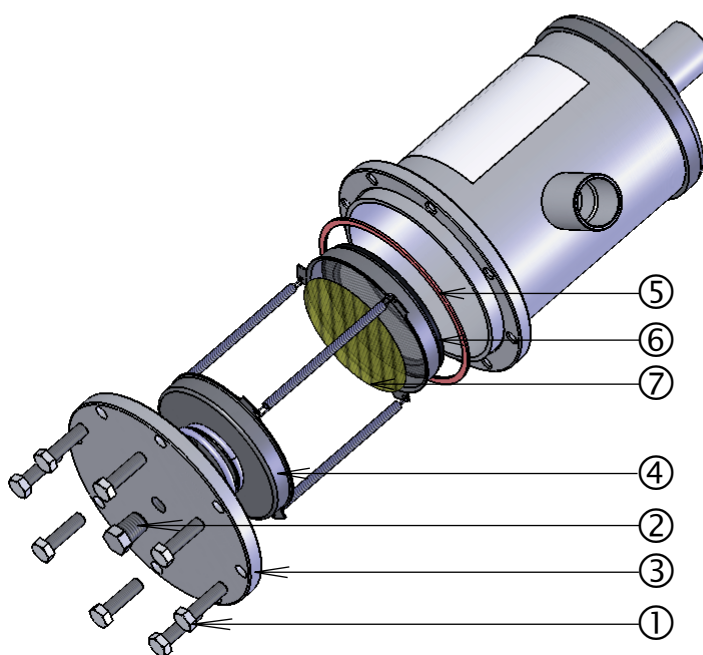



Replaceable core filter drier shells (liquid line)

→ **BCY** (corresponding cores: CCY 48 and PLATINIUM 48)

■ Weights and packaging

CARLY references	Unit weight kg		Packaging number of pieces
	With packaging	Without packaging	
BCY 485 S/MMS	4,45	4,20	1
BCY 487 S/MMS	4,55	4,30	1
BCY 489 S & MMS	4,65	4,40	1
BCY 4811 S/MMS	4,70	4,45	1
BCY 4813 S & MMS	4,80	4,55	1
BCY 4817 S/MMS	5,05	4,80	1
BCY 967 S/MMS	5,90	5,60	1
BCY 969 S & MMS	5,95	5,65	1
BCY 9611 S/MMS	6,15	5,85	1
BCY 9613 S & MMS	6,25	5,95	1

CARLY references	Unit weight kg		Packaging number of pieces
	With packaging	Without packaging	
BCY 9617 S/MMS	6,40	6,10	1
BCY 1449 S & MMS	7,20	6,85	1
BCY 14411 S/MMS	7,40	7,05	1
BCY 14413 S & MMS	7,45	7,10	1
BCY 14417 S/MMS	7,70	7,35	1
BCY 19213 S & MMS	8,65	8,25	1
BCY 19217 S/MMS	9,05	8,65	1

→ **BCY-HP (46 bar)** (corresponding cores: CCY 48 and PLATINIUM 48)

■ Selection table : Group 2 fluids (A1, A2L)

CARLY references	Connections To solder ODF inch	CARLY references	Connections To solder ODF mm	Refrigerating capacity kW ⁽¹⁾					Number of cores
				R22 R1233zd	R134a R407C R410A R407F	R404A R507A R452A	R1234ze R513A R448A R449A R450A	R744 ⁽²⁾ CO ₂	
				BCY-HP 485 S/MMS	5/8	BCY-HP 485 S/MMS	16	93,5	
BCY-HP 487 S/MMS	7/8	BCY-HP 487 S/MMS	22	152,0	139,0	100,0	121,0	171,0	1
BCY-HP 489 S	1 1/8	BCY-HP 489 MMS	28	206,0	188,0	135,0	163,5	232,0	1
BCY-HP 4811 S/MMS	1 3/8	BCY-HP 4811 S/MMS	35	246,0	225,0	161,0	196,0	277,0	1
BCY-HP 4813 S	1 5/8	BCY-HP 4813 MMS	42	298,5	273,0	195,0	237,5	336,0	1
BCY-HP 4817 S/MMS	2 1/8	BCY-HP 4817 S/MMS	54	348,5	319,0	228,0	277,5	392,0	1
BCY-HP 967 S/MMS	7/8	BCY-HP 967 S/MMS	22	156,0	143,0	102,0	124,5	176,0	2
BCY-HP 969 S	1 1/8	BCY-HP 969 MMS	28	234,0	214,0	153,0	186,0	264,0	2
BCY-HP 9611 S/MMS	1 3/8	BCY-HP 9611 S/MMS	35	332,5	304,0	217,0	264,5	375,0	2
BCY-HP 9613 S	1 5/8	BCY-HP 9613 MMS	42	408,0	373,0	267,0	324,5	460,0	2
BCY-HP 9617 S/MMS	2 1/8	BCY-HP 9617 S/MMS	54	412,0	377,0	269,0	328,0	464,0	2

⁽¹⁾ Refrigerating capacities according to Standard ARI 710-86 for To = -15 °C, Tk = 30 °C and Δp = 0.07 bar. If different conditions, refer to correction factors in chapter 112.

⁽²⁾ Refrigerating capacities Qn for Tk = -10 °C and To = -40 °C. If different conditions, refer to correction factors in chapter 112.

Nota: the diameter of connections must not be inferior to the diameter of the main pipe.



Replaceable core filter drier shells (liquid line)

→ BCY-HP (46 bar) (corresponding cores: CCY 48 and PLATINIUM 48)

■ Selection table : Group 1 fluids (A2, A2L, A3)

CARLY references	Connections To solder ODF inch	CARLY references	Connections To solder ODF mm	Refrigerating capacity kW ⁽¹⁾						Number of cores
				R143A R1234yf	R419A R431A R290 R433A R454C R443A R436A R436B R455A R441A R600a	R454A R413A R432A R444A R600 R601a	R430A R601 R406A R142B R411B R418A R429A R444B R454B R415A	R446 R447A R510A R415B R512A R152A R435A	R32	
BCY-HP 485 S/MMS	5/8	BCY-HP 485 S/MMS	16	59,8	68,3	78,5	92,6	105,7	118,7	1
BCY-HP 487 S/MMS	7/8	BCY-HP 487 S/MMS	22	97,3	111,0	127,7	150,5	171,8	193,0	1
BCY-HP 489 S	1 1/8	BCY-HP 489 MMS	28	131,8	150,4	173,0	203,9	232,8	261,6	1
BCY-HP 4811 S/MMS	1 3/8	BCY-HP 4811 S/MMS	35	157,4	179,6	206,6	243,5	278,0	312,4	1
BCY-HP 4813 S	1 5/8	BCY-HP 4813 MMS	42	191,0	217,9	250,7	295,5	337,3	379,1	1
BCY-HP 4817 S/MMS	2 1/8	BCY-HP 4817 S/MMS	54	223,0	254,4	292,7	345,0	393,8	442,6	1
BCY-HP 967 S/MMS	7/8	BCY-HP 967 S/MMS	22	99,8	113,9	131,0	154,4	176,3	198,1	2
BCY-HP 969 S	1 1/8	BCY-HP 969 MMS	28	149,8	170,8	196,6	231,7	264,4	297,2	2
BCY-HP 9611 S/MMS	1 3/8	BCY-HP 9611 S/MMS	35	212,8	242,7	279,3	329,2	375,7	422,3	2
BCY-HP 9613 S	1 5/8	BCY-HP 9613 MMS	42	261,1	297,8	342,7	403,9	461,0	518,2	2
BCY-HP 9617 S/MMS	2 1/8	BCY-HP 9617 S/MMS	54	263,7	300,8	346,1	407,9	465,6	523,2	2

⁽¹⁾ Refrigerating capacities according to Standard ARI 710-86 for $T_o = -15\text{ °C}$, $T_k = 30\text{ °C}$ and $\Delta p = 0.07\text{ bar}$.
If different conditions, refer to correction factors in chapter 112.

Nota: the diameter of connections must not be inferior to the diameter of the main pipe.



Replaceable core filter drier shells (liquid line)

→ BCY-HP (46 bar) (corresponding cores: CCY 48 and PLATINIUM 48)

■ Technical features

CARLY references	Connection types ⁽¹⁾	Filtering surface cm ²	Dimensions mm							
			Ø1	Ø2 ⁽²⁾	Ø3	L1	L2	E1	E2	
BCY-HP 485 S/MMS	2	420	121	128	150	223	210	139	83	
BCY-HP 487 S/MMS	2	420	121	128	150	233	210	149	93	
BCY-HP 489 S	BCY-HP 489 MMS	3	420	121	128	150	238	210	154	98
BCY-HP 4811 S/MMS		3	420	121	128	150	247	210	163	108
BCY-HP 4813 S	BCY-HP 4813 MMS	3	420	121	128	150	247	210	163	108
BCY-HP 4817 S/MMS		3	420	121	128	150	260	210	176	124
BCY-HP 967 S/MMS		2	840	121	128	150	373	210	289	93
BCY-HP 969 S	BCY-HP 969 MMS	3	840	121	128	150	378	210	294	98
BCY-HP 9611 S/MMS		3	840	121	128	150	387	210	303	108
BCY-HP 9613 S	BCY-HP 9613 MMS	3	840	121	128	150	387	210	303	108
BCY-HP 9617 S/MMS		3	840	121	128	150	400	210	316	124

⁽¹⁾ Chapter «Connection features and drawings» (refer to chapter 114).

⁽²⁾ Including weld.

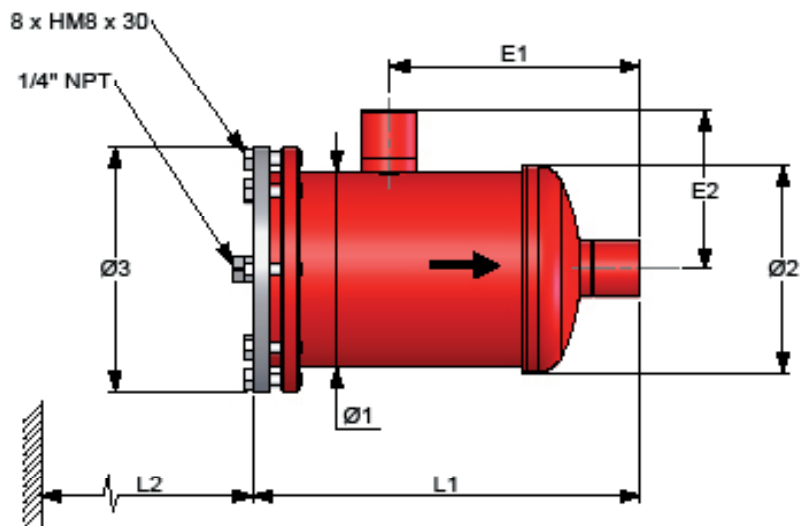



Replaceable core filter drier shells (liquid line)

→ BCY-HP (46 bar) (corresponding cores: CCY 48 and PLATINIUM 48)

■ Technical features

CARLY references	Volume	Maximal working pressure	Working pressure (1)	Maximal working temperature	Minimal working temperature	Working temperature (1)	CE Category (2)	
	V L	PS bar	PS BT bar	TS maxi °C	TS mini °C	TS BT °C	With fluids G2, A1 and A2L	With fluids G1, A2L, A2 and A3 (3)
BCY-HP 485 S/MMS	1,90	46	34	120	-40	-10	I	II
BCY-HP 487 S/MMS	1,90	46	34	120	-40	-10	I	II
BCY-HP 489 S	BCY-HP 489 MMS	1,90	46	34	120	-40	I	II
BCY-HP 4811 S/MMS		1,90	46	34	120	-40	I	II
BCY-HP 4813 S	BCY-HP 4813 MMS	1,90	46	34	120	-40	I	II
BCY-HP 4817 S/MMS		2,00	46	34	120	-40	I	II
BCY-HP 967 S/MMS		3,30	46	34	120	-40	I	II
BCY-HP 969 S	BCY-HP 969 MMS	3,30	46	34	120	-40	I	II
BCY-HP 9611 S/MMS		3,30	46	34	120	-40	I	II
BCY-HP 9613 S	BCY-HP 9613 MMS	3,30	46	34	120	-40	I	II
BCY-HP 9617 S/MMS		3,40	46	34	120	-40	I	II

(1) The working pressure is limited to the PS BT value when working temperature is lower than or equal to TS BT value.

(2) Classification by volume, according to PED 2014/68/EU (refer to chapter 0).

(3) It is essential to use the flat gasket for closing flange (blue) part no. CY 1555303

■ Spare parts

Shells	CARLY References for core holders	Quantity and type of gaskets for use		
		Core holders gasket (1)		End plate gasket (2)
BCY-HP 1 core	CY 37001070	1 gasket CY 1555200		1 Gasket (blue) CY 1555303
BCY-HP 2 cores	CY 37001030 + CY 37001090	2 gaskets CY 1555200		1 Gasket CY 1555601

(1) Gasket delivered with core holders

(2) Gasket delivered with cores CCY 48 N, CCY 48 HP and PLATINIUM 48

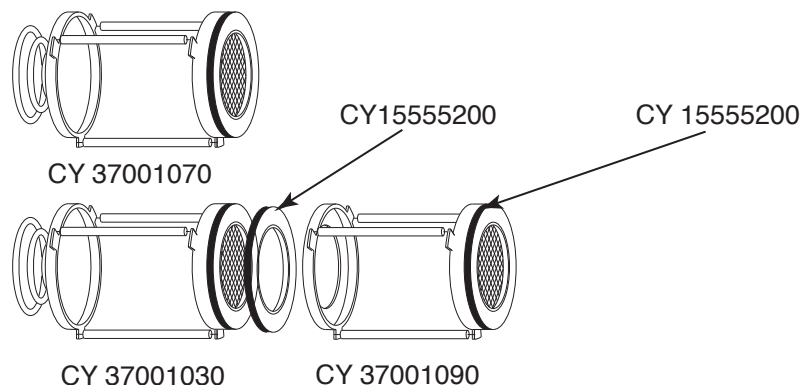



Replaceable core filter drier shells (liquid line)

→ BCY-HP (46 bar) (corresponding cores: CCY 48 and PLATINIUM 48)

■ Spare parts

CARLY references	Part N°	Désignation	Quantity
CY 19900411	1	Set of 8 fastening screws for end plate	1
CY 10810010	2	1/4" NPT phosphate plug for end plate	1
CY 33301200	2 + 3 + 5	1/4" NPT plug + end plate + gasket	1
CY 37001030	4	Core holder (2 cores)	1
CY 37001070	4	Core holder (1 core)	1
CY 37001090	4	Core holder (2 cores)	1
CY 15555601	5	End plate gasket (red)	1
CY 15555303	5	End plate gasket (blue)	1
CY 15555200	6	Adhesive gasket for core holders:: CY 37001030, CY 37001040, CY 37001080, CY37001070 and CY3700190	1
CCY A 48	7	Adapter for end core holder	1
CY 15555000		Bag of gaskets for shell end plates : CARLY and for most manufacturers (gaskets: 122 x 114 x 1.6 and 114 x 103 x 1.6)	1

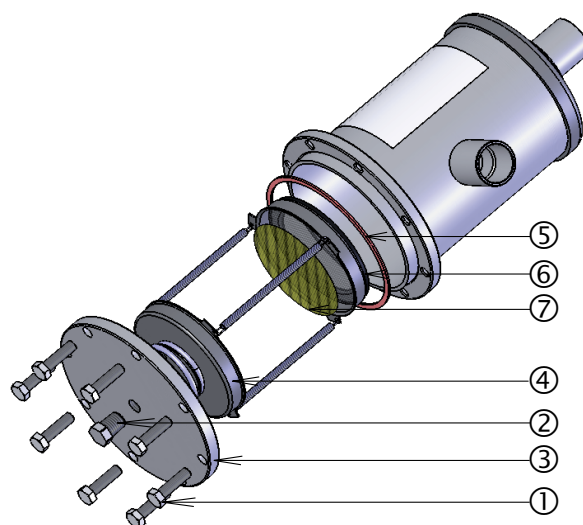

■ Weights and packaging

CARLY references	Unit weight kg		Packaging number of pieces	CARLY references	Unit weight kg		Packaging number of pieces
	With packaging	Without packaging			With packaging	Without packaging	
BCY-HP 485 S/MMS	4,45	4,20	1	BCY-HP 967 S/MMS	5,90	5,60	1
BCY-HP 487 S/MMS	4,55	4,30	1	BCY-HP 969 S & MMS	5,95	5,65	1
BCY-HP 489 S & MMS	4,65	4,40	1	BCY-HP 9611 S/MMS	6,15	5,85	1
BCY-HP 4811 S/MMS	4,70	4,45	1	BCY-HP 9613 S & MMS	6,25	5,95	1
BCY-HP 4813 S & MMS	4,80	4,55	1	BCY-HP 9617 S/MMS	6,40	6,10	1
BCY-HP 4817 S/MMS	5,05	4,80	1				